

FROM ENVIRONMENTAL CARE TO CONTRACTING

# Junkkari **CHIPPERS**

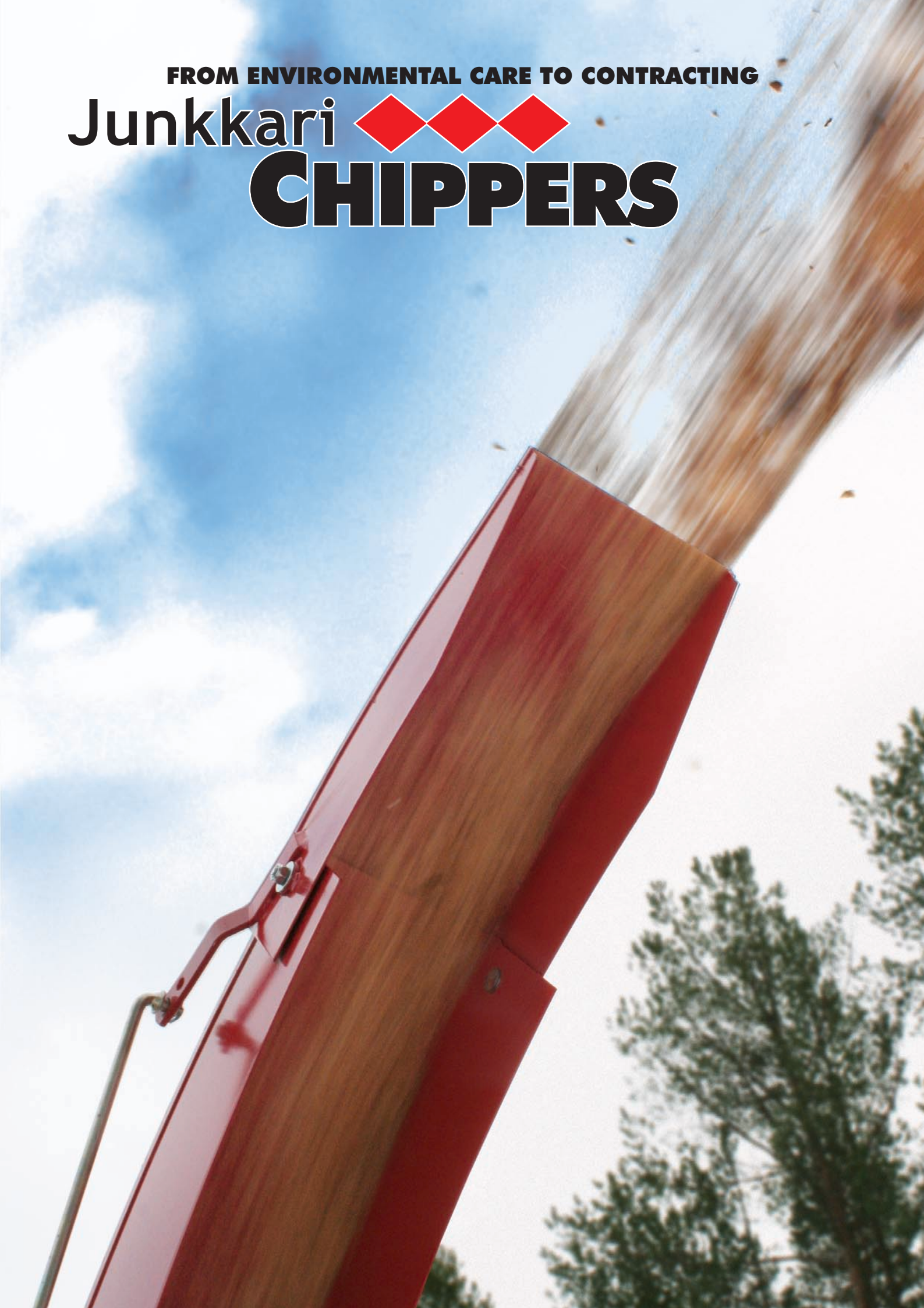



## SPEAKING FROM EXPERIENCE



The chip size of Junkkari chippers can be adjusted to your needs. The chips are of uniform quality, which makes them safe to use in demanding locations.

Junkkari produces disc chippers. Our company has thirty years of experience in manufacturing them and has produced a total of 10,000 chippers.

The principle of the disc chipper is to move the wood towards the cutting disc, which cuts the chips one at a time. The wood is fed into the chipper without a feeding device or by means of hydraulic feeding rollers. The roller speed is continuous and easy to adjust.

The chips end up on the blow wings on the outer perimeter of the discs. The chips are crushed, and the wings will blow the woodchips to the desired location through the discharge chute. Simple and functional!

The wooden material is planned for use as an energy source in the future and it will be increasingly popular, because it is becoming more and more competitive on the fluctuating world markets. See what pays and count a resistant and efficient Junkkari chipper in!



1

Junkkari's smallest HJ-4 chipper is ideal for environmental chipping and landscaping. It is a non-direct feeding chipper. The blades draw the wood in themselves, and it requires less power. The HJ-4 chipper comes in two versions, the M and the G models. The HJ-4 chipper can be used to chip wood with a diameter of up to 9 cm.

**Junkkari**  
**HJ-4**

**1** The HJ-4 M model is a mechanical chipper with no separate feeding device. It is particularly well-suited for chipping branchless trees and trees with only a few branches.



2

**2** The HJ-4 G model is a chipper with a hydraulic feeding device. It has one feed roller powered by the tractor's hydraulics.



3

**3** The three blades of the disc can be adjusted continuously to the desired wood-chip size. The blow wings will finalise the woodchips and blow the chips effectively to the desired location through an adjustable discharge chute.



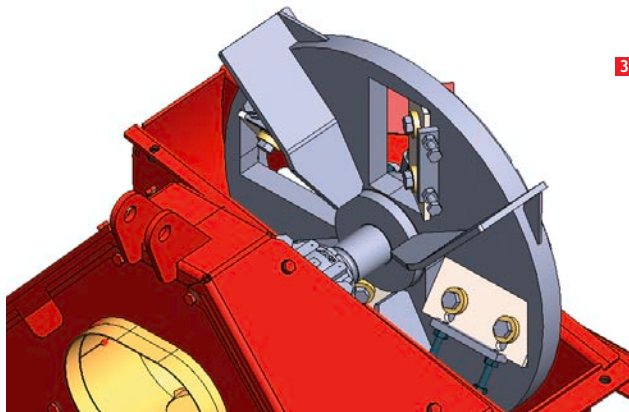

The new Junkkari HJ-170 chipper is suitable for chipping trees less than 17 cm in diameter. As the smaller model, this chipper also has a feeding angle of 45 degrees to the disc. The HJ-170 chipper comes in two versions, the M and the G models.

**1** The new modern design of HJ-170 chipper includes separate frame and several user friendly details. Chipper is available as M-model with no separate feeding device and also as G-model which is seen in the picture. The safety of user is secured also in the M-model with a patented feed stopper operated with the control handle.

**2** In the picture you can see a hydraulic feeding device of HJ-170 G. It has one feed roller powered by the tractor's hydraulics. The handle is used to control the rotation of the feed roller.

**3** The HJ-170 chipper has four blades that can be adjusted continuously depending on the desired woodchip size. The blow wings will finalise the woodchips and blow the chips effectively to the desired location through an adjustable discharge chute.



The new Junkkari HJ-250 chipper is ideal for chipping larger pieces of wood. This chipper is extremely popular abroad. Since it can be used for chipping wood up to 25 cm in diameter, it can be used to chip material for biofuels and wood used in parks and in energy sources.

## Junkkari HJ-250

HJ-250 is a non-direct feeding chipper. As the blades draw the wood in themselves, it requires less power. It comes in three versions: the M, G and GT models.



**1** The HJ-250 G model is a chipper with a hydraulic feeding device. Its two feed rollers are powered by the tractor's hydraulics. The HJ-250 GT model is almost identical to it: the only difference is that its feeding device has an independent hydraulic tank and pump. This means that no additional hydraulics is needed.

Third available version HJ-250 M is mechanical chipper without separate feeding device. For safety reasons all M-model chippers are equipped with a patented feed stopper operated with the control handle.

**2** The new discharge chute gives excellent airflow and easy adjustability.

**3** The HJ-250 chipper can be fitted with optional loader feeding equipment that contains the following elements: a stronger infeed chute, a No-Stress rotation guard and an electronic feed and discharge chute control.



# Junkkari HJ-260



The HJ-260 is a direct feed chipper for wood 25 cm in diameter. It is well-suited for producing biofuels and woodchips used as energy sources and in stoker boilers. The high-quality woodchips produced with direct feed chippers is particularly well-suited for use in stoker boilers, since the chipper cuts the wood to the cross fibre. The feed opening is at a 90 degree angle to the blade disk.

The HJ-260 chipper comes in two versions, the G and the GT models. The G model has a feeding device with two rollers, powered by the tractor's hydraulic system, while the GT model has a system with a hydraulic tank and pump of its own.

1 The HJ-260 equipped with a manual feed system.

2 The HJ-260 chipper can be fitted with optional loader feeding equipment that contains the following elements: a stronger infeed chute, a No-Stress rotation guard and an electronic feed and discharge chute control.

3 The discs of the HJ-250 and HJ-260 model come with four blades you can adjust continuously depending on the desired woodchip size. The blow wings will finalise the woodchips and blow the chips effectively to the desired location through an adjustable discharge chute.





The HJ-500 is a powerful trailed chipper that can be used to chip wood up to 45 cm in diameter.

The chipper is ideal for contracting work and can compete with any drum chipper in its size range. The significant advantage of the HJ-500 is its low energy consumption and its high productivity, as well as its extremely competitive price.

The feed opening of the HJ-500 model is set at a 45-degree angle at the front of the chipper. The tractor's cab allows an excellent view of the feed opening. The chipping material is easy to control, and it can be chipped smoothly and effectively.

The HJ-500 chipper can produce up to 100 m<sup>3</sup> of woodchips per hour. The woodchips are of uniform quality, and the chip size can be adjusted continuously depending on your needs.

**1** HJ-500 chipper can be combined with Junkkari Patruuna crane.

**2** The HJ-500 model with an infeed chute.

**3** The HJ-500 model with a modernised feed conveyor. The length of the conveyor is 150 cm, and it is now better suited for felling leftovers.







4

4 Depending on chipping conditions, the capacity of the HJ-500 model is 30 to 100m<sup>3</sup> per hour.

5 All of Junkkari's chippers that provide loader feeding come with a new Wizard C+ control unit as standard. This unit is used to control the direction of the discharge chute, the feed rollers and the No-Stress rotation guard. The feed rollers can also be controlled with foot pedals.

5





At home  
in the  
forest.



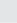

# Junkkari **CHIPPERS**

MODEL	HJ-4 M * G	HJ-170 M * G	HJ-250 M * G * GT	HJ-260 G * GT	HJ-500 C
Feed opening size (cm)	20 x 17	20 x 20	26 x 26	26 x 26	45 x 45
Blade disc diameter (cm)	43	74	94	87	138
Blade disc mass (kg)	45	106	172	170	650
Number of blades (pcs)	3	4	4	4	2 
Revolutions (r/min)	540-1000	540-1000	540-1000	540-1000	540-1000
Blade setting (mm)	4-12	3-20	3-20	3-18	5-20
Max wood diameter (cm)	10	17	25	25	45
Chipping capacity (m <sup>3</sup> /h)	2-6	4-8	7-20	7-20	30-100
Power requirement  (kW/hp)	10-35 / 14-50	20-50 / 27-70	20-66 / 27-90	30-75 / 40-100	80-150 / 110-200
Weight (kg)	172 * 250	520 * 550	640 * 670 * 710	740 * 770	2500
Length in working position (cm)	125 * 170	145 * 220	170 * 240 * 240	244	430-483
Length in transportation position (cm)	120 * 120	120 * 160	140 * 175 * 175	176	430-483
Width in working position (cm)	150 * 165	150 * 160	160 * 220 * 220	102	300
Width in transportation position (cm)	145 * 125	120 * 160	105 * 150 * 150	104	230
Height in transportation position (cm)	190	240	275	295	315
<b>EQUIPMENT</b>					
Hydr. feeding device/number of rollers	optional / 1	optional / 1	optional / 2	standard / 2	standard / 2
Hydr. feeding device with own hydraulics	optional	optional	optional	optional	standard
Chute extension	-	-	optional	optional 1m	optional 0,5 m
Brush wood blades for the disc	optional	optional	optional	optional	optional
Brush wood blades for the chamber	-	-	-	-	optional
No-stress	-	optional	optional	optional	standard
Loader feeding equipment	-	-	-	optional	standard
Upper chamber tilting cylinder	-	-	-	-	optional
Hydr. lifting of the upper feed roller	-	-	-	-	optional

 The blade adjustment, sharpness, setting and the size and type of wood to be chipped have a significant effect on the machine's power requirement.

 A blade consisting of two parts.

Junkkari chippers fulfill the safety norms.

How to consult the table: The asterisk (\*) on the line is used between different models (M \* G \* GT) to indicate their respective technical specifications.



The brush wood blade for the disc is attached to the chipper blade. The brush wood blades are used to ensure that high-quality woodchips are produced when chipping small pieces of wood and surface boards.

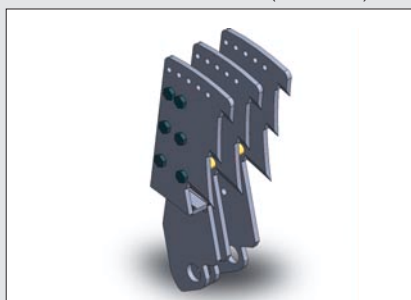

Brush wood blades for the chamber. Brush wood blades for the chamber are used in addition to the brush wood blades of the disc to ensure that the woodchips are of uniform quality. For the HJ-500 chipper only.



No Stress control Wizard C. The rotational guard of the manual feed chipper also features other practical functions such as an hour counter and a maintenance alarm.



## Partnership between professionals

Junkkari has been known for its reliability for over six decades. Today, Junkkari Oy is one of Finland's largest agricultural and forestry machines in Finland. Our company is part of the MSK Group.

We have earned our clients' trust through solid product development and by responding immediately to client queries. Thanks to your success, we too have been able to prosper. We plan to keep up the good work in the decades to come.

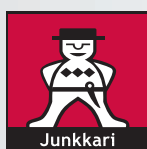

Manufacturing  
Junkkari Oy, FI-62375 Ylihärmä, Finland  
Tel. +358 10 480 2200  
Fax +358 10 480 2295  
E-mail: junkkari@msk.fi  
Internet: www.junkkari.fi

Sales